



**The maximum in security**  
at source suction and  
transport processes of dusts  
and gases in potentially  
**explosives atmospheres.**



**AIRBRAVO**  
Occupational Air Pollution Control



## **ATEX LINE SUCTION ARMS**



**The proper solution** for the localized  
suction during the industry processing for:

- Pharmaceutical
- Chemical
- Alimentary

**Compulsory in European Union beginning  
from 1st July 2006**



## **AIRBRAVO Suction Arm EPX: Safety for industry**

Type tested according to ATEX 94/9/CE\_EN Area II 2 D/G rules



### **Available in various versions:**

- **Galvanized Steel**
- **Stainless Steel AISI 316**
- **Polypropylene for Chemical agents**
- **For Food industry**

It's specially designed to extract gases, vapours and dusts in industrial areas with potentially explosive atmospheres. The EPX suction arm eliminates the possible build-up of electrostatic charges and avoids potential situations of explosion risk.

### **Types & Dimensions**

AIRBRAVO EPX ARMS INDUSTRY series		
Code	Diametr (mm)	Straddle (m)
EPX 1213	125	2
EPX 1216	160	
EPX 1220	200	
EPX 1225	250	
EPX 1312	125	3
EPX 1316	160	
EPX 1320	200	
EPX 1325	250	
EPX 1412	125	4
EPX 1416	160	
EPX 1420	200	



**Chemical Industry**



**Pharmaceutical Industry**



**Alimentary Industry**





**AIRBRAVO**  
Occupational Air Pollution Control

## **AIRBRAVO Suction Arm EPX: Safety for laboratory**

Type tested according to ATEX 94/9/CE\_EN Area II 2 D/G rules



It has been designed for the suction in laboratory areas of gases, vapours and dusts released by the handling of materials harmful for the operator and at high explosions risk.



### **Available in various Versions**

- Galvanized Steel
- Stainless Steel AISI 316
- Polypropylene for Chemical agents
- For Food industry

### **Pressure Drop**

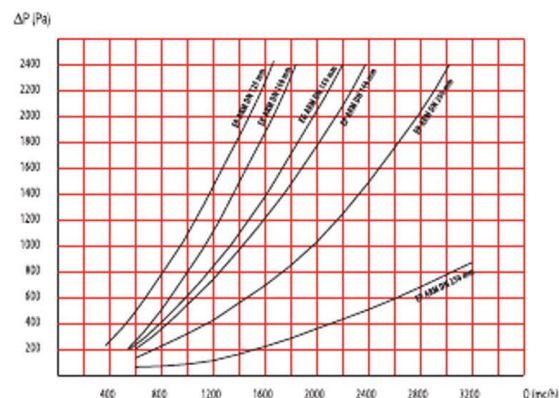

### **Types & Dimensions**

EPX SUCTION ARMS LABORATORY series		
Code	Diameter (mm)	Straddle (m)
EPX 1110	100	1
EPX 1112	125	
EPX 1210	100	2
EPX 1212	125	



Chemical Industry



Pharmaceutical Industry



Alimentary Industry

## Accessories ATEX LINE for Industry & Laboratory series

### Hoods



Multi-slot

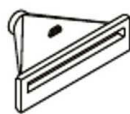

Single-slot



Dust and Vapours



Smokes

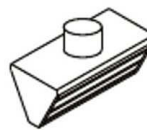

Double Face

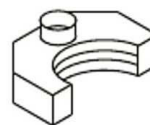

Semi-annular

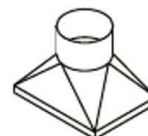

Canopy

### Wall Brackets



Table for Lab.

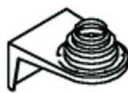

Wall for Lab.



Industry

### Jib extensions

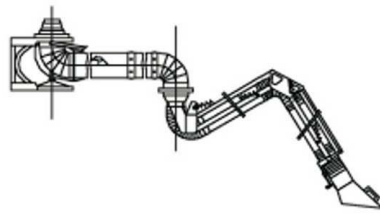

For working areas up to 8 meters

### Stands

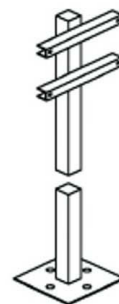

## Airbravo: Since 1976 leader in Suction and Filtration of air pollutants

Airbravo key production is represented by Suction Arms designed for maximum protection of the operators and the environment, by the suction at the source of polluting or toxic gases, smokes and dusts.

Airbravo arms fit strict production and quality standards and are characterized by high performances in terms of flexibility, strength and handling. Available in various versions and completed by a wide range of accessories, they're studied to be installed in every production line or process.

Now available also Suction Arms of the Atex Line for areas classified potentially explosive.

Técnicos de Captación y Servicios,s.l.  
C/Lezeaga,10 ( 48002 ) Bilbao-Bizkaia-  
Tfno. y fax: 94 442 20 77  
info@aspiracionyfiltracion.com  
www.aspiracionyfiltracion.com



**AIRBRAVO**

Occupational Air Pollution Control

www.airbravo.com - info@airbravo.com

